

# Portalite™



## TOP:

Top design	Two piece folding, square corners, 3-layer foam
Standard size	25" x 69"
Foam - 2 layer	3/4" firm bottom, 1-3/4" medium density middle, urethane polymer
Polyester batting	1/2" fluffy polyester Dacron top layer
Frame	3/4" x 1-3/4" poplar rails, 3/16" plywood top, poplar blocks
Side arm holes	3 holes per side spaced 9" apart

## TOP OPTIONS:

Top Option	Optional size 22" x 69"
Stationary side arms	4" x 15", no extra holes needed

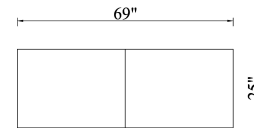

## VINYL CHOICES:

Ultra Soft Touch - standard	Lightly textured, Super Soft Urethane vinyl, fabric backed, environmentally friendly
-----------------------------	--

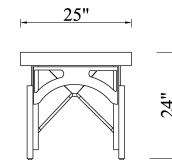

## LEGS:

Height range	<b>Quick-open CenterLock leg system with low end plates</b> 24" to 34" - 9 positions
4" leg recess	4" recess from ends of table
Low end plate position	15" knee space between bottom plate and lower table edge
Leg room - width	16.75" inside distance between legs at the end of the table
Leg design	Quick-open, no pins, nylon fittings connect leg parts
CenterLock Legs	1" x 1-3/8" maple legs, 3/4" diameter wood dowels
Cables	3/32" steel (49 wires) PVC-coated (1/8" O.D.)
Cable end crimps	Tested to over 1500 lbs. pull
Adjustable leg extension	Attaches to 1/4" leg bolt with star knob, 9 holes, felt backed, rubber foot

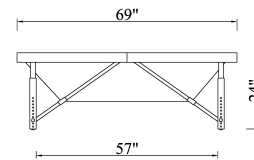

## GUARANTEES:

Structure	5 yrs.
Foam	5 yrs.
Vinyl	Guaranteed to arrive in good condition

## WEIGHTS:

Weight	26 lbs.
Shipping weight - boxed	36 lbs. 40" x 27" x 10"

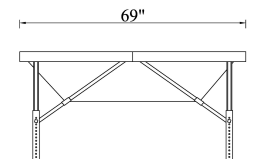

Rev 7/1/07



PO Box 1304 Dimmocks Mill Rd  
International: 919.732.6968

Toll Free: 800.678.6824

Fax: 919.732.1173