

HiLo PowerTilt



TOP:

Top design
Adjustments

Four piece adjustable top with round corners, 3-layer foam, 3/4" plywood
Motorized adjustment of height from 17" to 36" (ADA compliant)
Easy Motorized adjustments of torso, knee, and upper body sections
Available with footswitch controls or hand controls

Standard size top
Foam
Polyester batting
Frame

30" x 73"
2" firm bottom layer + 1- 3/4" medium-density layer of urethane polymer
1/2" fluffy polyester Dacron top layer
3/4" Plywood frame reinforced for arm rests and face cradle

TOP OPTIONS:

Widths - custom
Sidearms
Head rest
Foot extension
Neck Bolster

27" and 33" widths available with lead times and \$100 upcharge
60 degree elevating side arm rests
Quick Touch or Crescent Face Support available for either end of table
See price list and package upgrades
See price list and package upgrades

VINYL CHOICES:

Ultra Soft Touch - standard
Custom Color

Lightly textured, Super Soft Urethane vinyl, fabric backed, environmentally friendly
Available with \$100 upcharge + customer provides fabric to TA

Base and Frame

Carbon Steel Base
8" leg recess
Height range - standard
Lifting Weight
Capacity

Sleek, contemporary design with white powder coat finish
8" recess from ends of table
17" to 36" (infinite motorized adjustment)
Lifting weight capacity 325 pounds
Static weight capacity 600 lbs.

GUARANTEES:

Structure
Foam
Motor and Controls
Vinyl

10 yrs
5 yrs
1 yr
Guaranteed to arrive in good condition

WEIGHTS:

Table Weight
Shipping weight - boxed

245 lbs.
300 lbs (83" x 35" x 39" = 66 cu ft)

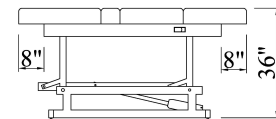
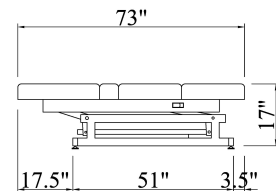
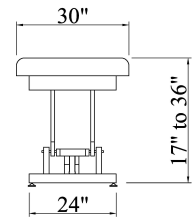
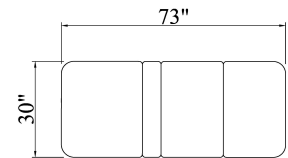

Rev 7/1/07



TouchAmerica
evolving the spa experience

PO Box 1304 Dimmocks Mill Rd
International: 919.732.6968

Toll Free: 800.678.6824

Fax: 919.732.1173