

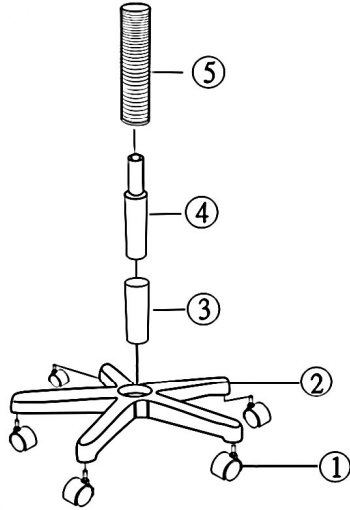

# Assembly Instructions for Drafting Chair No . DC204

## PARTS LIST

KEY	QTY	DESCRIPTION	KEY	QTY	DESCRIPTION	KEY	QTY	DESCRIPTION
1	5	Casters	6	1	Seat Plate	11	1	Backrest Depth Adj knob & Washers
2	1	Base	7	1	Seat Cushion	12	1	Backrest
3	1	Extension Tube	8	6	Seat Plate Screws & Washers	13	1	Backrest Connector
4	1	Gas Cylinder	9	1	Footrest	14	2	Backrest Screws
5	1	Cylinder Cover	10	1	Backrest Support and Cover			



### STEP 1.

Insert casters (key 1) into base (key 2). Insert extension tube (key 3) and gas cylinder (key 4) into base and slide cylinder cover (key 5) over top.

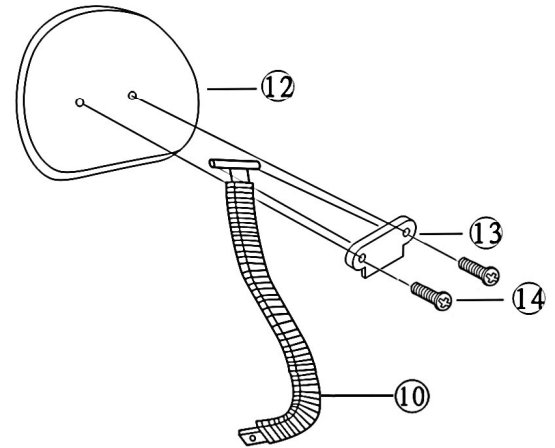

### STEP 2.

Use backrest screws (key 14) and backrest connector (key 13) to attach backrest support (key 10) to backrest (key 12).

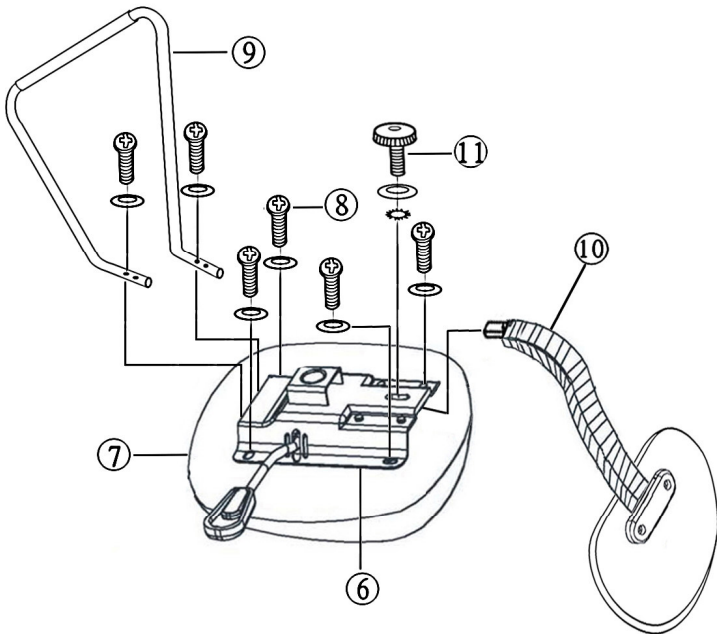

### STEP 3.

Align seat plate (key 6) and footrest (key 9) to bottom of seat cushion (key 7) and attach using seat plate screws and washers (key 8) . Tighten screws securely. Insert backrest support (key 10) into seat plate and secure with backrest depth adjustment knob and washers (key 11).

### STEP 4.

Place the seat cushion assembly on top of the base assembly and adjust to desired height.

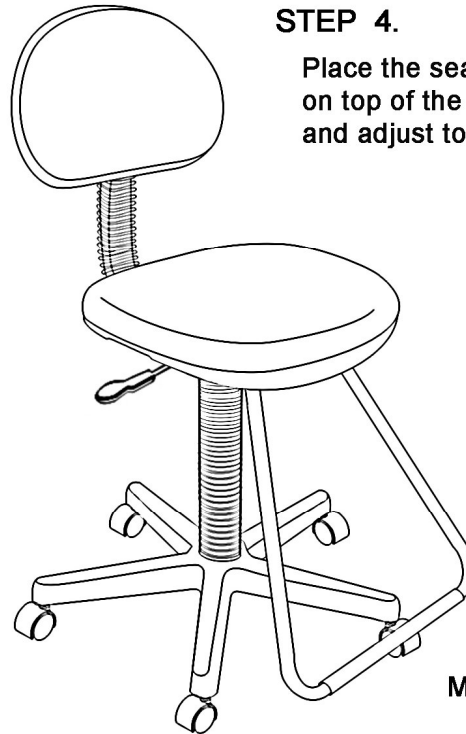

Made in Taiwan

#### PREVENTIVE MAINTENANCE AND WARNING

- USE THIS PRODUCT ONLY FOR SEATING ONE PERSON AT A TIME.
- DO NOT USE CHAIR AS STEP STOOL/LADDER.
- DO NOT USE CHAIR UNLESS ALL BOLTS, SCREWS AND KNOBS ARE TIGHT. AT LEAST EVERY SIX MONTHS, CHECK ALL BOLTS, SCREWS AND KNOBS TO BE SURE THEY ARE TIGHT.
- IF ANY PARTS ARE MISSING, BROKEN, DAMAGED OR WORN, STOP USE OF THE PRODUCT UNTIL REPAIRS ARE MADE USING FACTORY AUTHORIZED PARTS.
- FAILURE TO FOLLOW THESE WARNINGS CAN RESULT TO SERIOUS INJURY.

