



GENERAL PRODUCT INFORMATION:



This product is suitable for indoor dry locations only.

This product must be used with Tech Lighting Presto, Staccato, Rhapsody, Serenade & Espressione Chandeliers



Extend the Chandelier

NOTE: Refer to the instructions provided with the chandelier to install the backplate before proceeding with steps below.

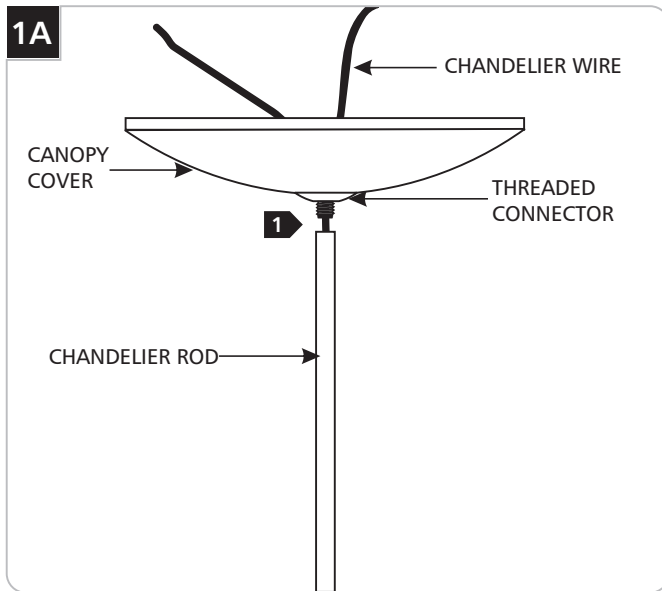

1 Unscrew the canopy cover completely from the chandelier rod. **DO NOT SHORTEN THE CHANDELIER WIRE.**

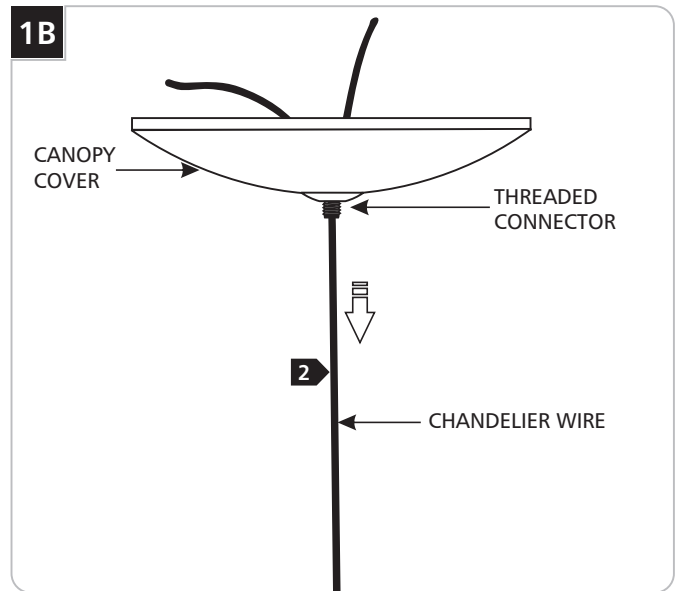

2 Pull the chandelier wire out of the canopy cover. **DO NOT DISASSEMBLE THE CANOPY COVER.**

1C

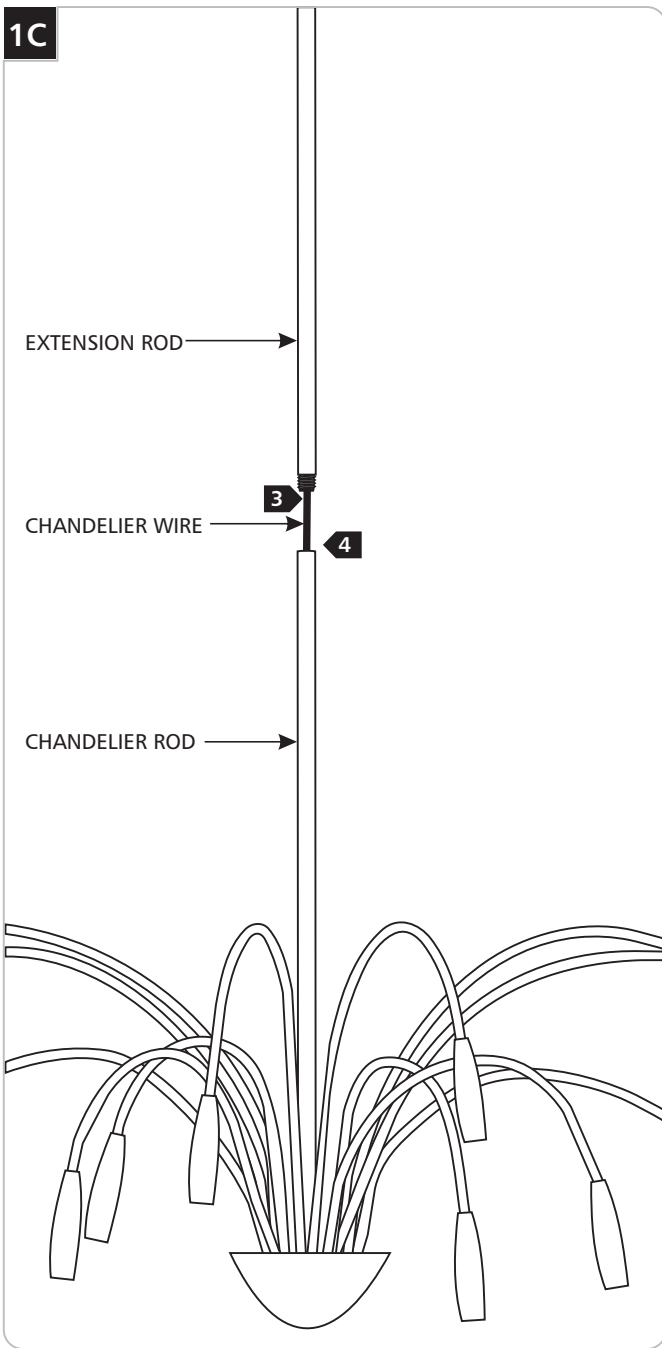

- 3** Feed the chandelier wire through the threaded side of the extension rod.
- 4** Screw the extension rod completely to the chandelier rod tight.

1D

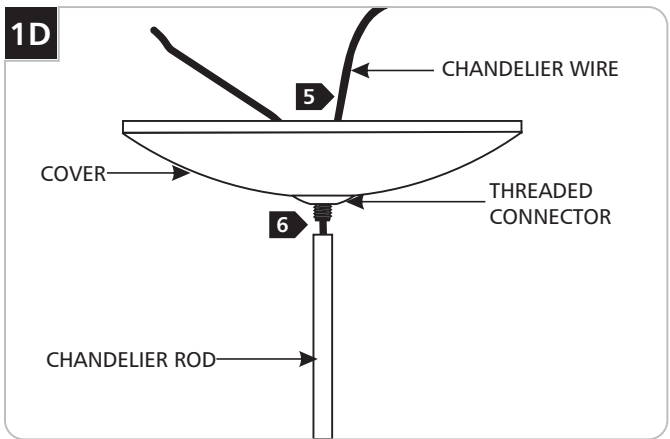

- 5** Feed the chandelier wire through the threaded connector into the canopy cover.
- 6** Screw the canopy cover completely to the chandelier rod tight.
- 7** Refer to the instructions provided with the chandelier and follow the "Mounting the Chandelier" steps to complete the installation.

SAVE THESE INSTRUCTIONS!



TECH LIGHTING®

7400 Linder Ave.
Skokie, IL 60077
847.410.4400

www.techlighting.com